

- 1
- 2
- 3
- 4
- 5
- 6
- 7
- 8
- 9
- 10
- 11
- 12
- 13
- 14
- 15
- 16
- 17
- 18
- 19

STANDARD EXECUTIONS

Turned and black-oxide steel:

- **GN 75-D**: threaded blind hole.
- **GN 75-E**: threaded pin

Steel zinc plated, blue passivated:

- **GN 75-D-ZB**: threaded blind hole.
- **GN 75-E-ZB**: threaded pin

SPECIAL EXECUTIONS ON REQUEST

AISI 316 stainless steel executions.

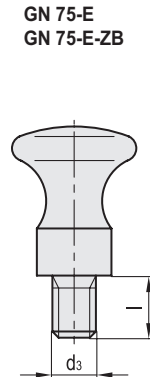
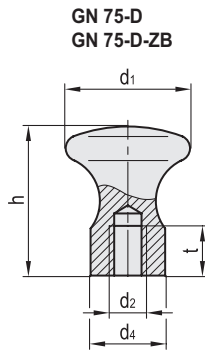

Conversion Table	
1 mm = 0.039 inch	
d1	
mm	inch
16	0.62
20	0.78
25	0.98
32	1.25
36	1.40

GN 75-D

METRIC

Code	Description	d1	d2	d4	h	tmin	⚖️
GN.38551	GN 75-16-M5-D	16	M 5	10	18	7	10
GN.38555	GN 75-20-M6-D	20	M 6	12	24	9	22
GN.38559	GN 75-25-M6-D	25	M 6	14	29	9	42
GN.38563	GN 75-32-M8-D	32	M 8	18	37	12	76
GN.38567	GN 75-36-M10-D	36	M 10	20	42	15	118

GN 75-E

METRIC

Code	Description	d1	d3	d4	h	l	⚖️
GN.38553	GN 75-16-M6-E	16	M 6	10	18	10	14
GN.38557	GN 75-20-M8-E	20	M 8	12	24	12	28
GN.38561	GN 75-25-M8-E	25	M 8	14	29	14	46
GN.38565	GN 75-32-M10-E	32	M 10	18	37	16	87
GN.38569	GN 75-36-M12-E	36	M 12	20	42	18	138

GN 75-D-ZB

Code	Description	d1	d2	d4	h	tmin	⚖️
GN.38552	GN 75-16-M5-D-ZB	16	M 5	10	18	7	11
GN.38556	GN 75-20-M6-D-ZB	20	M 6	12	24	9	22
GN.38560	GN 75-25-M6-D-ZB	25	M 6	14	29	9	43
GN.38564	GN 75-32-M8-D-ZB	32	M 8	18	37	12	84
GN.38568	GN 75-36-M10-D-ZB	36	M 10	20	42	15	120

GN 75-E-ZB

Code	Description	d1	d3	d4	h	l	⚖️
GN.38554	GN 75-16-M6-E-ZB	16	M 6	10	18	10	15
GN.38558	GN 75-20-M8-E-ZB	20	M 8	12	24	12	28
GN.38562	GN 75-25-M8-E-ZB	25	M 8	14	29	14	50
GN.38566	GN 75-32-M10-E-ZB	32	M 10	18	37	16	99
GN.38570	GN 75-36-M12-E-ZB	36	M 12	20	42	18	145

Fixed & Revolving handles